

SCOTT COUNTY ENGINEER'S OFFICE

950 E. Blackhawk Trail
Eldridge, Iowa 52748

(563) 326-8640
FAX – (563) 328-4173
E-MAIL - engineer@scottcountyiowa.com
WEB SITE - www.scottcountyiowa.com



ANGELA K. KERSTEN, P.E.
County Engineer

ELLIOTT R. PENNOCK, E.I.T.
Assistant County Engineer
MEMO

TARA YOUNGERS
Senior Administrative Assistant

TO: Mahesh Sharma
County Administrator

FROM: Angie Kersten, P.E.
County Engineer

SUBJ: Park View Storm Sewer Televising Contract

DATE: February 22, 2021

One of the top priorities in the Scott County Iowa Strategic Plan for FY 2021 and FY 2022 is to determine Park View’s service/infrastructure needs vs. resources to address. In order to prioritize and plan roadway improvements in Park View, it is critical that we know what the condition and capacity of the existing storm sewers are. The existing storm sewer ranges from 2 years old to over 50 years old. The storm sewer was designed by the developers and was designed to control storm water runoff during the time period it was built. As surrounding land use has changed and engineering design practices have improved based on data collected from past storm occurrences, it is reasonable to assume that the existing system may have inadequate capacity and/or have deteriorated beyond design life.

In September 2020, we entered into a contract with MSA Professional Services, Inc., to provide professional design services for storm sewer analysis in Park View. The intent of this project is to determine the condition of the existing storm sewers, the existing capacity, the recommended pipe sizes based on current and future conditions, and incorporate the information into our existing GIS database. The scope of MSA’s work included assembling a request for proposals from qualified contractors to perform storm sewer televising. MSA solicited quotes from six companies and quotes received are as follows:

AccuJet Sewer and Drain Cleaning, Perry, IA	No Quote
CIT Sewer Solutions, McCallsburg, IA	\$89,640.00
Hydro-Klean, LLC, Des Moines, IA	\$50,954.00
Kline Sewer & Drain, Eldridge, IA	\$75,263.60
Municipal Pipe Tool Company, Hudson, IA	No Quote
Visu-Sewer, Mason City, IA	No Quote

I recommend entering into a contract with Hydro-Klean, LLC, contingent on the unit prices listed in the contract. The fee to perform this work was included in our FY 2020 and FY 2021 budgets. The unspent budgeted dollars from FY 2020 have been carried over in FY 2021 and this cost is included in my budget amendment request for March 2021. Included with this memo is the contract with Hydro-Klean, LLC, and a project location map.

Park View Storm Water Drainage System Analysis

Scott - ICEASB Easy Map

3:04 PM, Thu, Jul 2, 2020

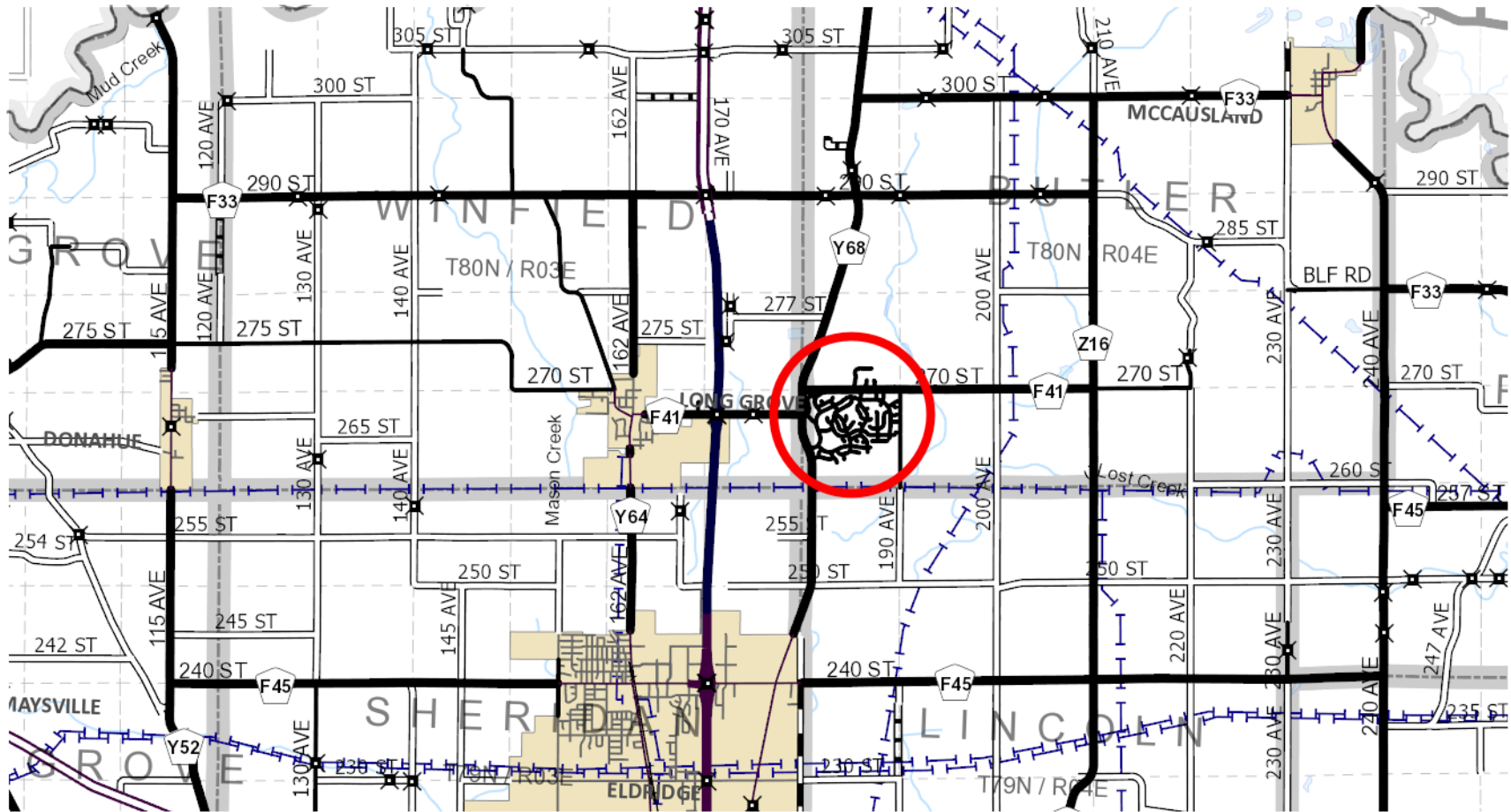

Feature Key

- | | | | | |
|-------------|------------|-----------|-----------------|----------------|
| Earth | Gravel | Seal Coat | County Pavement | State Pavement |
| Divided Hwy | Water | City | Township | Railroad |
| Bridge | County Hwy | State Hwy | US Hwy | |

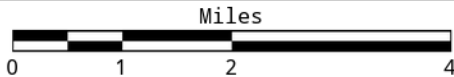

1
2
3 **AGREEMENT**

4 THIS AGREEMENT is by and between SECONDARY ROAD DEPARTMENT OF SCOTT
5 COUNTY, IA (hereinafter called OWNER) and Hydro-Klean, LLC (hereinafter called
6 CONTRACTOR).

7 OWNER and CONTRACTOR, hereby agree as follows:
8

9 **ARTICLE 1 - WORK**

10 1.01 CONTRACTOR shall complete all Work as specified or indicated in the Request for
11 Proposal and attached to this AGREEMENT. The Work is generally described as follows:
12 Storm sewer system televising, Park View, Scott County, IA
13

14 **ARTICLE 2 - ENGINEER**

15 2.01 The Project has been solicited by MSA Professional Services, Inc., 2117 State Street, Suite
16 200, Bettendorf, IA 52722 which is to act as Owner's representative, assume all duties and
17 responsibilities, and have the rights and authority assigned to Engineer in the Contract
18 Documents in connection with the completion of the Work in accordance with the Contract
19 Documents.
20

21 **ARTICLE 3 - CONTRACT TIMES**

22 3.01 *Time of the Essence*

23
24 A. All time limits for Milestones, if any, Substantial Completion, and completion and
25 readiness for final payment as stated in the Contract Documents are of the essence
26 of the Contract.
27

28 3.02 *Dates for Substantial Completion and Final Payment*

29
30 A. The Work will be completed and ready for final payment on or before April 16,
31 2021.
32

33 **ARTICLE 4 - CONTRACT PRICE**

34 4.01 OWNER shall pay CONTRACTOR for completion of the Work in accordance with the
35 Contract Documents an amount in current funds equal to the sum of the amounts
36 determined pursuant to Paragraph 5.01.A. and 5.01.B below:
37

38 A. For all Unit Price Work, an amount equal to the sum of the established unit price
39 for each separately identified item of Unit Price Work times the actual quantity of
40 that item. The Bid prices for Unit Price Work set forth as of the Effective Date of
41 the Agreement are based on estimated quantities. Actual quantities are to be
42 provided to the Engineer for application of payment.

1
2 B. For all Work, at the prices stated in Contractor's Bid, attached hereto as an exhibit.
3

4 **ARTICLE 5 - PAYMENT PROCEDURES**

5 5.01 *Submittal and Processing of Payments*

6
7 A. CONTRACTOR shall submit an Application for Payment with the deliverables on
8 or before the substantial completion date of April 16, 2021. Application for
9 Payment will be prepared by the ENGINEER and processed by the OWNER.
10

11
12 **ARTICLE 6 - CONTRACTOR'S REPRESENTATIONS**

13 6.01 In order to induce OWNER to enter into this Agreement, CONTRACTOR makes the
14 following representations:
15

16 A. CONTRACTOR has examined and carefully studied the Contract Documents and
17 the other related data identified in the Bidding Documents.
18

19 B. Contractor has considered the information known to Contractor; information
20 commonly known to contractors doing business in the locality of the Site;
21 information and observations obtained from visits to the Site; the Contract
22 Documents; and the Site-related drawings identified in the Contract Documents,
23 with respect to the effect of such information, observations, and documents on (1)
24 the cost, progress, and performance of the Work; (2) the means, methods,
25 techniques, sequences, and procedures of construction to be employed by
26 Contractor, including any specific means, methods, techniques, sequences, and
27 procedures of construction expressly required by the Contract Documents; and (3)
28 Contractor's safety precautions and programs.
29

30 C. The Contract Documents are generally sufficient to indicate and convey
31 understanding of all terms and conditions for performance and furnishing of the
32 Work.
33

34 **ARTICLE 7 - CONTRACT DOCUMENTS**

35 7.01 *Contents*

36
37 A. The Contract Documents consist of the following:
38

39 1. This Agreement (pages 00 52 00-1 to 00 52 00-5, inclusive).
40

41 2. Request for Proposal, including:
42

43 a. Park View storm sewer system map;

- 1 b. Specifications;
- 2 c. Liability Insurance requirements;
- 3 d. Certificates of Insurance;
- 4 e. Indemnification Clause
- 5
- 6 3. Contractor's bid
- 7
- 8 B. There are no Contract Documents other than those listed above in this Article 7.
- 9

10 **ARTICLE 8 - MISCELLANEOUS**

12 8.01 *Assignment of Contract*

- 13
- 14 A. No assignment by a party hereto of any rights under or interests in the Contract will
 - 15 be binding on another party hereto without the written consent of the party sought
 - 16 to be bound; and, specifically but without limitation, moneys that may become due
 - 17 and moneys that are due may not be assigned without such consent (except to the
 - 18 extent that the effect of this restriction may be limited by law), and unless
 - 19 specifically stated to the contrary in any written consent to an assignment, no
 - 20 assignment will release or discharge the assignor from any duty or responsibility
 - 21 under the Contract Documents.

22

23 8.02 *Successors and Assigns*

- 24
- 25 A. OWNER and CONTRACTOR each binds itself, its partners, successors, assigns,
 - 26 and legal representatives to the other party hereto, its partners, successors, assigns,
 - 27 and legal representatives in respect to all covenants, agreements and obligations
 - 28 contained in the Contract Documents.

29

30 8.03 *Severability*

- 31
- 32 A. Any provision or part of the Contract Documents held to be void or unenforceable
 - 33 under any Law or Regulation shall be deemed stricken, and all remaining provisions
 - 34 shall continue to be valid and binding upon OWNER and CONTRACTOR, who
 - 35 agrees that the Contract Documents shall be reformed to replace such stricken
 - 36 provision or part thereof with a valid and enforceable provision that comes as close
 - 37 as possible to expressing the intention of the stricken provision.

38

39 8.04 *Contractor's Certifications*

- 40
- 41 A. CONTRACTOR certifies that it has not engaged in corrupt, fraudulent, collusive,
 - 42 or coercive practices in competing for or in executing the Contract. For the
 - 43 purposes of this Paragraph 8.04:

1
2
3
4
5
6
7
8
9
10
11
12
13
14
15
16

1. “corrupt practice” means the offering, giving, receiving, or soliciting of any thing of value likely to influence the action of a public official in the bidding process or in the Contract execution;
2. “fraudulent practice” means an intentional misrepresentation of facts made (a) to influence the bidding process or the execution of the Contract to the detriment of OWNER, (b) to establish Bid or Contract prices at artificial non-competitive levels, or (c) to deprive OWNER of the benefits of free and open competition;
3. “collusive practice” means a scheme or arrangement between two or more BIDDERS, with or without the knowledge of OWNER, a purpose of which is to establish Bid prices at artificial, non-competitive levels; and
4. “coercive practice” means harming or threatening to harm, directly or indirectly, persons or their property to influence their participation in the bidding process or affect the execution of the Contract.

1 IN WITNESS WHEREOF, OWNER and CONTRACTOR have signed this Agreement.
2 Counterparts have been delivered to OWNER and CONTRACTOR. All portions of the Contract
3 Documents have been signed or have been identified by OWNER and CONTRACTOR or on their
4 behalf.

5
6 This Agreement will be effective on _____, _____ (which is the Effective Date of the
7 Agreement).

8
9 OWNER:
10
11 SECONDARY ROAD DEPARTMENT OF
12 SCOTT COUNTY, IA

13
14
15
16 By: _____
17 Angela Kersten, Scott County Engineer

25
26 CONTRACTOR:
27
28
29
30
31
32 By: _____

33
34
35 (Corporate Seal)

36
37 Attest _____

38
39
40 Address for giving notices:
41
42
43
44

45 License No. _____
46 (where applicable)

47
48 Agent for service of process:
49
50 _____

51 (If Contractor is a corporation, a partnership,
52 or a joint venture, attach evidence of
53 authority to sign.)

REQUEST FOR PROPOSAL

STORM SEWER TELEVISIONING SCOTT COUNTY: PARK VIEW, IA

MSA Professional Services is requesting proposals on the following information outlined in this document. Please review all attached documents for maps, specifications, insurance requirements, and documentation standards and return on or before 3:00 P.M. on February 19, 2021 to MSA Professional Services, Inc., 2117 State Street, Suite 200, Bettendorf, IA 52722 Attn: Kevin Bailey, P.E. Upon review of all proposals received, MSA will make a recommendation of approval to the Scott County Engineer. The Scott County Engineer reserves the right to reject all proposals. The contractor whose proposal is accepted will enter into a contract directly with the Scott County Secondary Roads Department.

Location: Park View, Scott County, IA

Collection System: 16,128 LF of Storm Sewer Pipe, 3,544 LF of Culverts, and 30 Storm Manholes. See attached map (Attachment A) for location of pipes, culverts and structures.

Scope: The Contractor shall perform storm sewer televising work as necessary to thoroughly document the condition of all sewers and manholes. This includes root cutting, tap cutting, removal of deposits/scaling, cleaning, televising, inspection, and documentation of Park View's storm sewer system. Finally the contractor shall provide a recommendation for every section of pipe and manhole surveyed (IE: no action, rehab, reconstruction, etc.)

Proper documentation is crucial because the intent of the work being completed is to collect data that needs to be formatted with correct sewer and manhole numbers and uniform rating standards to allow MSA to input the data collected into an automated GIS mapping application that will show defect location, type of defect, and severity of defect via numerical scoring. This data will be used to develop an improvement plan for Park View's storm sewers.

A map (Attachment "A") shows the approximate locations to be televised and inspected. Location and amount of work may be adjusted prior to Contractor starting work. Storm sewer from storm intakes along the driveway of Neil Armstrong Elementary School are not to be televised. Manhole inspections and DIP sheets have already been completed. Televising of Manholes shall be completed. A recording of the televising along with a report of findings shall be delivered to MSA Professional Services, Inc. at 2117 State Street Suite 200, Bettendorf, IA 52722 upon completion. The report shall include ratings of the condition of the pipes and manholes to the current NASSCO PACP & MACP standards. The report shall also include recommendations for any needed rehabilitation of the sewer lines and manholes. The contractor shall perform all work according to the attached specifications (Attachment "B").

Deliverables: 3 hard copies of Storm Sewer Inspection Report
3 electronic copies of Televising Videos and Inspection Report

Summary of Cost:

	Est. Qty	Unit price	Total price
1. Mobilization	1 LS	\$ _____	\$ _____
2. Obstruction Removal (Root cutting, tap cutting, solids removal)* ¹	16 HRS	\$ _____ per HR	\$ _____
3. Storm Sewer Inspection, Televising, and Report* ²	19,672 LF	\$ _____ per LF	\$ _____
4. Storm Manhole Televising, and Report* ²	30 EACH	\$ _____ EACH	\$ _____
TOTAL			\$ _____

*¹ Obstruction removal time will only be paid for when obstructions need to be removed to facilitate televising of lines.

*¹ Any time above the 16 hours bid will be approved by Owner and Engineer prior to work being performed.

*¹ Dispose of debris at the Scott County Secondary Roads Department per specifications.

*² County will provide water at the Scott County Secondary Roads Department per specifications (contractor will not operate any hydrants or valves without Owner permission).

*² The actual length of sewer or number of manholes televised may be adjusted to conform to the County's budgetary constraints. Only actual quantities will be paid. Quantity shown includes storm sewer pipe and culvert length combined.

Work Completion Date: April 16, 2021

Quote Due date: February 19, 2021

Attachments: Attachment A – Sewer map with approximate inspection locations
Attachment B – Specifications
Attachment C – Insurance requirements

Submitted by: _____
Name of Company

Signed: _____ Date: _____
Signature

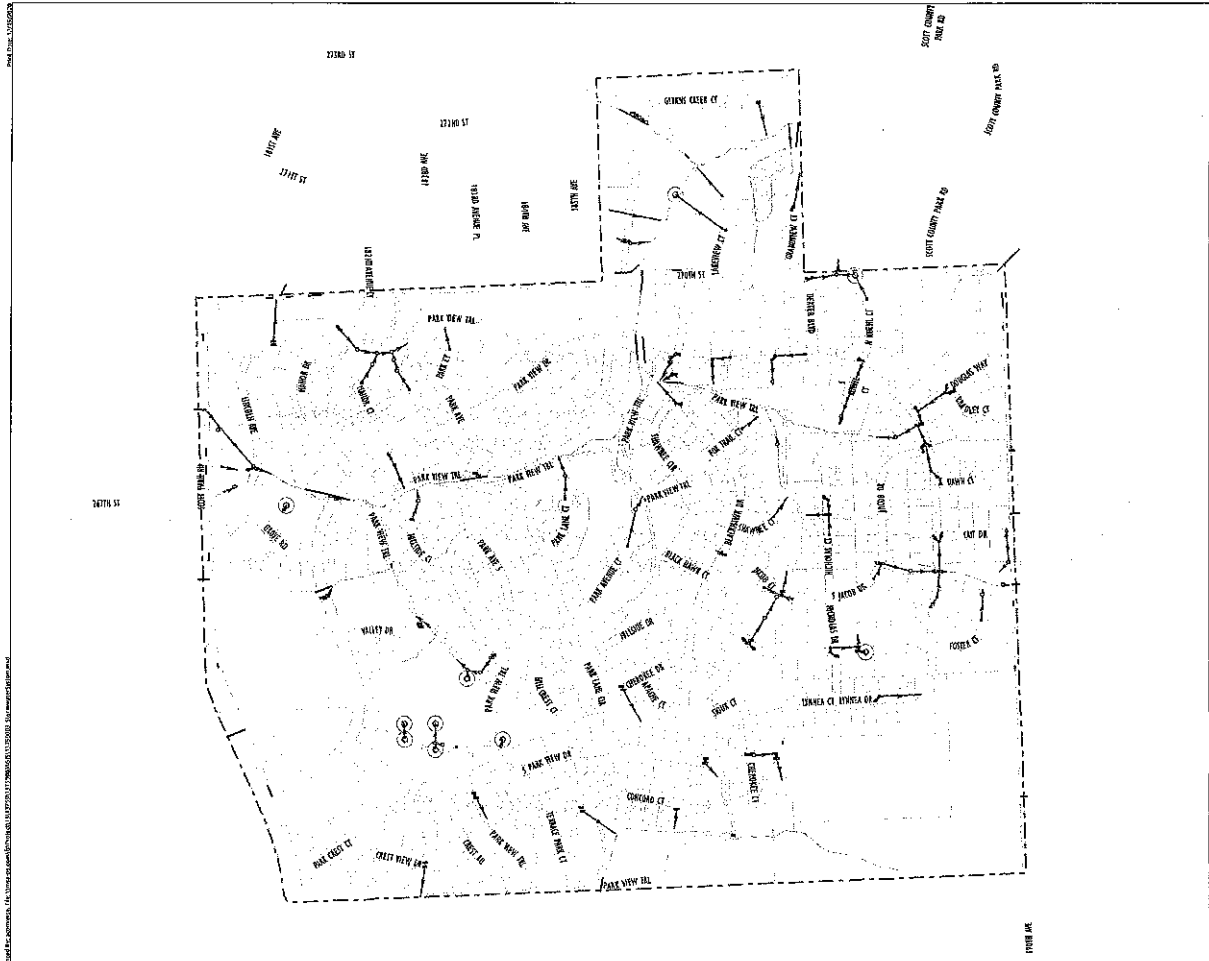

Stormwater System Map

Park View
Scott County, IA

- Park View
- Parcel
- Building Footprint
- Waterbodies
- Waterlines
- Stormwater Pipe
- Stormwater Culvert
- Manhole
- Standard Inlet
- Double Inlet
- Triple Inlet
- Pipe Connection Not Found (10)

Data Sources:
Roads: Scott County
Parcels: Scott County
Stormwater System: MSA Survey

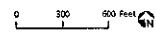

1
2
3
4
5
6
7
8
9
10
11
12
13
14
15
16
17
18
19
20
21
22
23
24
25
26
27
28
29
30
31

STORM SEWER CLEANING, TELEVISIONING, AND DATA FORMATTING

PART 1 GENERAL

1.01 APPLICABLE PROVISIONS

A. Applicable Provisions of Division 01 shall govern work of this section.

1.02 DESCRIPTION OF WORK

A. The work under this section shall include cleaning and televising of storm sewers and structures (manholes).

B. The intent of sewer line cleaning is to remove foreign materials from the lines and restore the sewer to a minimum of 95% of the original carrying capacity. The intent of televising is to record the condition of the sewer pipe and stormwater structure in accordance with the standards established by the National Association of Sewer Service Companies Pipeline Assessment and Certification Program and National Association of Sewer Service Companies Manhole Assessment and Certification Program (NASSCO PACP & MACP).

C. The intent of the data formatting is to provide required CCTV inspection data in a database format structure to allow an automated GIS mapping application to occur that will show defect location, type of defect, and severity of defect via numerical scoring.

1.03 PERMITS

A. Contractor shall obtain all necessary permits to work in either county or state roadways.

1.04 RELATED WORK ELSEWHERE

A. Traffic Control – Division 01

1.05 SUBMITTALS

A. CONTRACTOR shall submit viewing software to ENGINEER for review prior to conducting televising.

B. CONTRACTOR shall submit to ENGINEER a sample inspection log for review prior to televising.

C. CONTRACTOR shall submit to ENGINEER an outline of the summary report for review prior to televising.

1 D. CONTRACTOR shall submit to ENGINEER a proposed work schedule prior to
2 cleaning and televising.

3 PART 2 PRODUCTS AND MATERIALS

4 2.01 CLEANING EQUIPMENT

5 A. High-Velocity Jet Equipment shall be used on this project. All high-velocity sewer
6 cleaning equipment shall be constructed for ease and safety of operation and shall
7 carry its own water tank.

8 B. The equipment shall have a selection of two or more high-velocity nozzles. The
9 nozzles shall be capable of producing a scouring action from 15 to 45 degrees in all
10 sized designated lines.

11 C. Equipment shall also include a high-velocity gun for washing and scouring stormwater
12 structure walls and floor. The gun shall be capable of producing flows from a fine
13 spray to a solid stream.

14 D. A vacuum truck shall be used to remove heavy accumulations of material.

15 2.02 TELEVISIONING EQUIPMENT

16 A. The television camera used for the inspection shall be one specifically designed and
17 constructed for such inspection. Risers shall be used on televising tractors to ensure
18 that the camera is above the water level.

19 B. Camera shall have full pan and tilt capabilities. Camera shall be able to rotate on its
20 axis to cover a horizontal and vertical arc of at least 180 degrees in front of the
21 televising unit.

22 C. Camera shall be operable in 100% humidity conditions.

23 D. Lighting for the camera shall be suitable to allow a clear picture for the entire
24 periphery of the pipe and shall be sufficient for use with color inspection cameras, and
25 for diameters up to the largest pipe specified in this project.

26 E. The camera shall have a minimum resolution of 650 lines and shall provide a color
27 picture. Picture quality and definition shall be to the complete satisfaction of the
28 ENGINEER and if unsatisfactory, equipment shall be removed and no payment made
29 for unsatisfactory inspection.

30 F. CONTRACTOR shall provide to the ENGINEER a digitally formatted (VHS will not
31 be allowed) record, with software allowing quick "point and click" referencing of
32 defective pipe sections by computer on a DVD.

1 G. Measurement for location of defects as shown on the contract drawings shall be at the
2 ground level by means of a meter device. Marking on cable or the like which would
3 require interpolation for depth of stormwater structure, etc., will not be allowed.
4 Measurement meters shall be accurate to 0.2 of a foot. A measuring target (or the
5 sealing packer) in front of the television camera shall be used as an exact measurement
6 reference point and the meter reading shall show this exact location of the
7 measurement reference point.

8 PART 3 CONSTRUCTION METHODS

9 3.01 CLEANING

10 A. The cleaning equipment shall remove dirt, grease, rocks, sand, and other materials and
11 obstructions from the sewer lines and stormwater structures. If cleaning of an entire
12 section cannot be successfully performed from one stormwater structure, the
13 equipment shall be set up on the other stormwater structure and cleaning again
14 attempted. No additional payment allowance shall be made for reverse set-ups. If,
15 again, successful cleaning cannot be performed or the equipment fails to traverse the
16 entire stormwater structure section, it will be assumed that a major blockage exists
17 and the cleaning effort shall be abandoned.

18 B. CONTRACTOR shall determine the location of major blockage(s) by measuring the
19 length of hose or rod inserted from stormwater structures at each end and
20 immediately report location of blockage(s) to ENGINEER. CONTRACTOR shall
21 then record these conditions in a field log. ENGINEER shall be immediately notified
22 CONTRACTOR of any and all conditions which warrant the termination of cleaning
23 activities.

24 C. All sludge, dirt, sand, rock, grease, and other solid or semisolid material resulting
25 from the cleaning operation shall be removed at the downstream stormwater structure
26 of the section being cleaned. Passing material from stormwater structure section to
27 stormwater structure section, which could cause line stoppages, accumulations in wet
28 wells, or damage pumping equipment, is not permitted.

29 D. All solids or semi-solids resulting from the cleaning operations shall be removed from
30 the site and disposed. All materials shall be removed from the site no less often than
31 at the end of each workday. Under no circumstances will the CONTRACTOR be
32 allowed to accumulate debris, etc., on the site of work beyond the stated time, except
33 as approved by the Owner.

34 E. If the CONTRACTOR requires water for cleaning operations, Scott County
35 Secondary Roads Department will offer water supply for no charge from their facility
36 located at 950 E. Blackhawk Trail, Eldridge, IA 52748. Contact Scott County
37 Secondary Roads Department at (563) 326-8640 to coordinate access to water
38 supply. Water supply access is available Monday through Friday between the hours

1 of 7:00 a.m. and 3:30 p.m. (excluding holidays). No additional compensation will be
2 made for travel to and from the job site and Scott County Secondary Roads
3 Department. This work is incidental to the televising of storm sewer pipes.

4 3.02 OFF-ROAD CLEANING AND TELEVISIONING

- 5 A. All cleaning and televising which takes place off-road shall be conducted with
6 equipment specifically designed for this purpose. Any damage to property shall be
7 restored to pre-televising and cleaning condition at the CONTRACTOR's expense.

8 3.03 TELEVISIONING DIGITAL RECORDING

- 9 A. The televising camera shall be moved through the line in either direction at a uniform
10 rate, stopping when necessary to insure proper documentation of the sewer's
11 condition. In no case will the television camera move through the line at a speed
12 greater than 30 feet per minute. If the camera is to be pulled through the line, the
13 cable or device used to pull it shall in no way obstruct the quality of the televising.

- 14 B. During the inspection operation if the television camera will not pass through the
15 entire sewer section, the CONTRACTOR shall re-setup his equipment in a manner so
16 that the inspection can be performed from the opposite stormwater structure. If on
17 the re-setup the camera again fails to pass through the entire sewer section, the
18 inspection shall be considered terminated and no additional inspection work will be
19 required. No additional payment for re-setup due to an obstruction in the sewer that
20 does not allow the camera to pass shall be considered. No additional payment for
21 overlapping sections of televised pipe shall be considered.

- 22 C. All sags encountered in the system shall be documented.

- 23 D. Televised data acquisition shall consist of:

- 24 1. Computer recorded televising footage that utilizes software created
25 specifically for sewer televising, and that is acceptable to the Engineer.
26 NASSCO PACP & MACP compliant software is preferred.
27 2. Recordings which shall include the following information:
28 a. Visual (On screen in corner):
29 1) Footage of entire traverse through section of sewer.
30 2) Date of television inspection.
31 3) On-screen overview of entire section of sewer and adjoining
32 stormwater structures, with areas of degradation labeled.
33 4) Sewer section and number (provided).
34 5) Current distance along reach (counter footage).
35 6) Printed labels on container (DVD) with location information,
36 date, format information, and other descriptive information.

1
2
3
4
5
6
7
8
9
10
11
12
13
14
15
16
17
18
19
20
21
22
23
24
25
26
27
28
29
30
31
32
33
34
35
36
37
38
39
40
41
42
43
44
45

- b. Audio Commentary:
 - 1) Date and time of television inspection, operator name, name of overlying or adjacent street, and stormwater structure numbers (provided).
 - 2) Verbal confirmation of sewer section and television direction in relation to direction of flow.
 - 3) Verbal description of pipe size, type, and pipe joint length.
 - 4) Verbal description and location of each service connection and pipe defect.
 - 5) Type of weather during inspection.
- 3. Inspection logs made in the field and kept by the CONTRACTOR which shall include, but are not limited to, the following:
 - a. Date, time, city, street, basin, sewer section, reference stormwater structure number (provided), name of operator, inspector, and weather conditions.
 - b. Pipe diameter, pipe material, section length, depth of pipe, length, depth of pipe, length between joints, pipe number (provided) and corresponding videotape identification.
 - c. Location of each point of leakage.
 - d. Location of any damaged sections, nature of damage, and location with respect to pipe axis.
- 4. Deflection in alignment of grade of pipe.
- 5. An estimate of the flow rate of observed infiltration points shall be made and recorded. In addition, other points of significance such as locations of joints, unusual conditions, roots, collapsed sections, presence of scale and corrosion, and other discernible features will be recorded.
- 6. Televising that has been recorded in a digital format to provide a visual and audio record of the condition. This digital format data shall be saved on DVD for use by the ENGINEER. Contractor shall save a backup copy of the recorded inspection in his system and files.
- 7. Recordings that play back at the same speed that they were recorded.
- 8. A complete recording of each line televised. A voice recording shall be provided with brief and informative comments on the sewer conditions.
- 9. A summary report done by a computer containing the information in the inspection logs.
- 10. Upon completion of the televising, 3 copies of each of the following shall be presented to the Engineer:
 - 1) Digital recording in DVD format with voice commentary.
 - 2) Viewing software
 - 3) A computer generated written report summarizing the information in the inspection logs by basin and sewer section
 - 4) The inspection logs of all areas televised containing clear labeling of all pipe degradation. This labeling system shall be arranged to allow ease of referencing with respect to the televised sections of pipe on the DVD.

1 3.04 DATABASE REQUIREMENTS

2 A. Contractor shall perform inspection work and provide Engineer with one (1) copy of
3 the inspection database. Database shall be provided, formatted, or modified to meet
4 the following requirements:

- 5 1. The software can export to the standard Access database and be PACP &
6 MACP compliant.
- 7 2. The software can import from the standard PACP & MACP or Access
8 database.
- 9 3. The software will be compatible with Microsoft Windows XP, 2000 and
10 Windows 7.
- 11 4. The footage reading from the camera equipment shall be automatically entered
12 into the Survey Log.
- 13 5. Common information as specified by the PACP & MACP standard such as
14 defects/defect codes, severity index code(1-5), pipe materials, survey purpose,
15 defect location distance from starting stormwater structure, defect camera
16 position(clock), image paths for both MPEG and JPEG movies.
- 17 6. Severity Index for each defect will be coded on a 1-5 scale regardless of the
18 standard software scoring system.
- 19 7. If the television inspection of an entire section (stormwater structure to
20 stormwater structure) cannot be successfully performed from one stormwater
21 structure, a reverse setup shall be performed per PACP & MACP requirement
22 as a second survey. Both of these inspections shall be displayed as a single
23 report in Pipe Graphic and Tabular Reports.
- 24 8. PACP & MACP Quick Rating Report will be available.

25 B. Additionally, the required database format shall provide the following information at a
26 minimum:

- 27 1. Inspection Sessions Table
 - 28 a. Session ID (Unique Inspection Event)
 - 29 b. Client, Inspected Street name
 - 30 c. Inspection Date
 - 31 d. Inspection Direction (StreamDir),
 - 32 e. (Provided) Stormwater Structure ID# From, Stormwater Structure
33 ID# To
 - 34 f. Main Material, Main Size
 - 35 g. Televised Inspection Length,
 - 36 h. General Location Info for Stormwater Structure From*
 - 37 i. General Location Info for Stormwater Structure To*
 - 38 j. Observed Flow during inspection
 - 39 k. Quick Maintenance Rating – per PACP & MACP
 - 40 l. Quick Structural Rating – per PACP & MACP
 - 41 m. Inspection Company
 - 42 n. Inspection Date

- 1 2. Summary Inspection Observations Table
- 2 a. Data (Fault Observation) ID
- 3 b. Session ID (Inspection ID as listed from Session table above)
- 4 c. Fault Code (*Note Database shall include Fault Code table with code
- 5 definitions)
- 6 d. Fault Code Text
- 7 e. Fault Comments
- 8 f. Fault Distance (Fault distance as measured from beginning stormwater
- 9 structure)
- 10 g. Severity Index or Score
- 11 h. Position of Default (clock)
- 12 i. JPEG file name & Directory Location
- 13 j. MPEG filename & Directory Location
- 14 k. Structural Grade (per PACP & MACP)
- 15 l. Cored-in or break-in connection location – footage and clock position
- 16 m. Still-frame photos of all points of interest with image path
- 17

18 3.05 TRAFFIC CONTROL

- 19 A. It shall be the responsibility of the Contractor to provide traffic control during
- 20 construction of the project. All traffic control devices shall be in accordance with
- 21 Traffic Control – Division 01 and the current edition of the Manual on Uniform
- 22 Traffic Control Devices (MUTCD).

- 23 B. The Contractor shall furnish, erect, and maintain all necessary traffic control devices
- 24 required to provide safe movement of vehicular and pedestrian traffic through the
- 25 Project during the entire period from the start of the Contractor’s operations to the
- 26 final completion thereof. Traffic control devices include, but are not limited to,
- 27 barricades, warning signs, trailers, flashers, cones, drums, pavement markings, and
- 28 flaggers as required and sufficient barricade weights to maintain barricade stability.

- 29 C. The Contractor shall be responsible for the immediate repair or replacement of all
- 30 traffic control devices that become damaged, moved, or destroyed, of all lights that
- 31 cease to function properly, and of all barricade weights that are damaged, destroyed,
- 32 or otherwise fail to stabilize barricades. The Contractor will further provide sufficient
- 33 surveillance of all traffic control devices at least once every 24 hours.

- 34 D. It shall be the Contractor's responsibility to notify the State and County Department’s
- 35 of Transportation and adjacent property owners prior to the start of work and
- 36 coordinate the installation and removal of said signage upon completion of the
- 37 project. These entities may have additional traffic control requirements or require
- 38 permits to work in the right of way. The contractor is responsible for any such
- 39 permits and/or associated costs.

1 3.06 RETRIEVAL OF EQUIPMENT

2 A. If it becomes necessary to excavate for equipment retrieval, the Contractor shall be
3 responsible for restoring the sewer section disturbed in the retrieval efforts, to the
4 satisfaction of the municipality, backfilling and restoring the disturbed ground surface
5 to the pre-retrieval conditions or better. All materials and labor involved in the
6 equipment retrieval, including restoration of the sewer and ground surface described
7 above shall be incidental to the contract, and shall not be compensated for separately.
8 It shall be the duty of the Contractor to obtain any necessary permits needed for
9 excavation from the City, County, or State.

10 3.07 FIELD QUALITY CONTROL

11 A. Acceptance of sewer line cleaning shall be made upon the successful completion of
12 the television inspection and shall be to the satisfaction of the Owner and
13 ENGINEER.

14 3.08 DISPOSAL OF MATERIAL

15 A. It is the Contractor's duty to dispose of all material. All material shall be disposed at
16 the Scott County Secondary Roads Department (OWNER), 950 East Blackhawk
17 Trail, Eldridge, IA 52748. Disposals shall be coordinated with Scott County
18 Secondary Roads Department by calling (563) 326-8640. All disposals shall take
19 place Monday thru Friday between the hours of 7:00 a.m. and 3:30 p.m. (excluding
20 holidays). All disposal must be in compliance with all state and federal laws.

21 B. Scott County Secondary Roads Department will not provide any equipment or
22 hauling of material for disposal. All disposal of material will be the responsibility of
23 the contractor.

24 PART 4 MEASUREMENT AND PAYMENT

25 4.01 GENERAL

26 A. Storm Sewer Televising shall be paid for at the bid price in accordance with one of the
27 following methods, unless indicated otherwise in the Bid Schedule or Special
28 Procedures – Division 01.

29 B. All work specified herein shall be considered in each of the measurement and payment
30 method(s) stipulated, unless indicated otherwise in the Bid Schedule or Special
31 Procedures – Division 01.

32 4.02 STORM SEWER TELEVISIONING

33 A. Storm Sewer Televising, Linear Foot (diameter). Measurement for storm sewer
34 televising shall be per lineal foot of a specific diameter televised and shall include all

1 pre-inspections, meetings and coordination, line cleaning and disposal of debris,
2 televising work, database formatting, and all deliverables.

3 B. No additional payments shall be made for overlapping areas of sewer encountered
4 while cleaning or televising from two directions.

5
6

END OF SECTION

ATTACHMENT C

Contractor's Liability Insurance

The Contractor shall provide coverage for not less than the following amounts or greater where required by Laws and Regulations:

1. Workers' Compensation and related coverages under Paragraphs 5.04.A.1 and A.2 of the General Conditions:
 - a. State: Statutory
 - b. Applicable Federal (e.g., Longshoreman's): Statutory
 - c. Employer's Liability:
 - Bodily Injury by Accident-\$100,000
Each Accident
 - Bodily Injury by Disease - \$100,000
Each Employee
 - Bodily Injury by Disease - \$500,000
Policy Limit

2. Contractor's General Liability under Paragraphs 5.04.A.3 through A.6 of the General Conditions which shall include completed operations and product liability coverages.
 - a. General Aggregate \$2,000,000
 - b. Products-Completed Operations Aggregate \$2,000,000
 - c. Personal and Advertising Injury \$1,000,000
 - d. Each Occurrence (Bodily Injury and Property Damage) \$1,000,000
 - e. Property Damage liability insurance will provide Explosion, Collapse, and Underground coverages where applicable. Provide X, C, U Standard
 - f. Excess or Umbrella Liability:
 - General Aggregate \$5,000,000
 - Each Occurrence \$5,000,000

3. Automobile Liability under Paragraph 5.04.A.6 of the General Conditions:
 - a. Combined Single Limit (Bodily Injury and Property Damage Each Accident) \$1,000,000

4. The Contractual Liability coverage required by Paragraph 5.04.B.3 of the General Conditions shall provide coverage for not less than the following amounts:
- a. Bodily Injury:
 - Each Person \$1,000,000
 - Each Accident \$2,000,000
 - b. Property Damage:
 - Each Accident \$1,000,000
 - Annual Aggregate \$2,000,000

CERTIFICATES OF INSURANCE

Certificates of Insurance, acceptable to Scott County indicating insurance required by the Contract is in force, shall be filed with the County prior to approval of the Contract by the County. The Contractor shall insure that coverages afforded under the policies will not be cancelled until at least thirty (30) days prior written notice has been given to the County. The Contractor will accept responsibility for damages and the County's defense in the event no insurance is in place and the County has not been notified.

INDEMNIFICATION

To the fullest extent permitted by the law, the Contractor shall defend, indemnify, and hold harmless the County, its officials and its agents and employees from and against all claims, damages, losses and expenses, including but not limited to, all attorneys' fees arising out of or resulting from the performance of the work, provided that any such claim, damage, loss or expense

- (1) is attributable to bodily injury, sickness, disease or death, or to injury to or destruction of tangible property (other than the Work itself), including the loss of use resulting therefrom; and
- (2) is caused in whole or in part by any negligent act or omission of the Contractor, any Subcontractor, anyone directly or indirectly employed by any of them or anyone for whose acts any of them may be liable.

In any and all claims against the County, its officials or any of its agents or employees by any employee of the Contractor, any Subcontractor, anyone directly or indirectly employed by any of them or anyone for whose acts any of them may be liable, the indemnification obligation under this Paragraph shall not be limited in anyway by any limitation on the amount or type of damages, compensation or benefits payable by or for the Contractor or any Subcontractor under workers' or workmen's compensation acts, disability benefit acts or other employee benefit acts.

THE COUNTY AUDITOR'S SIGNATURE CERTIFIES THAT
THIS RESOLUTION HAS BEEN FORMALLY APPROVED BY
THE BOARD OF SUPERVISORS ON _____
DATE

SCOTT COUNTY AUDITOR

R E S O L U T I O N

SCOTT COUNTY BOARD OF SUPERVISORS

March 4, 2021

APPROVAL OF THE CONTRACT TO PERFORM STORM SEWER

TELEVISIONING SERVICES IN PARK VIEW

BE IT RESOLVED by the Scott County Board of Supervisors as follows:

Section 1. That Scott County enters into a contract with Hydro-Klean, LLC, to perform storm sewer televising services in Park View.

Section 2. That the County Engineer be authorized to sign the contract document on behalf of the Board.

Section 3. That this resolution shall take effect immediately.