

THE COUNTY AUDITOR'S SIGNATURE CERTIFIES THAT  
THIS RESOLUTION HAS BEEN FORMALLY APPROVED BY  
THE BOARD OF SUPERVISORS ON \_\_\_\_\_  
DATE

\_\_\_\_\_  
SCOTT COUNTY AUDITOR

R E S O L U T I O N

SCOTT COUNTY BOARD OF SUPERVISORS

APRIL 25, 2024

AWARD OF CONTRACT FOR SCOTT COUNTY SECONDARY ROADS

HMA MAINTENANCE PATCHING PROJECT

BE IT RESOLVED by the Scott County Board of Supervisors as follows:

Section 1. That the contract for HMA Maintenance Patching Project be awarded to Valley Construction Company contingent on the submitted unit prices.

Section 2. That the County Engineer be authorized to sign the contract documents on behalf of the Board.

Section 3. That this resolution shall take effect immediately.

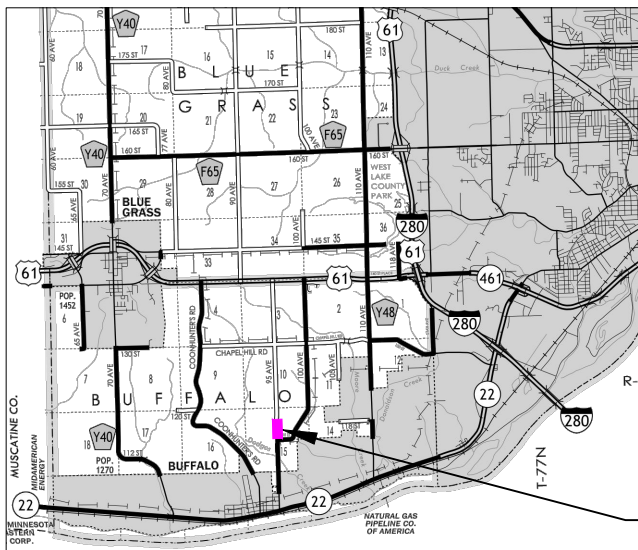

95th Ave Patch

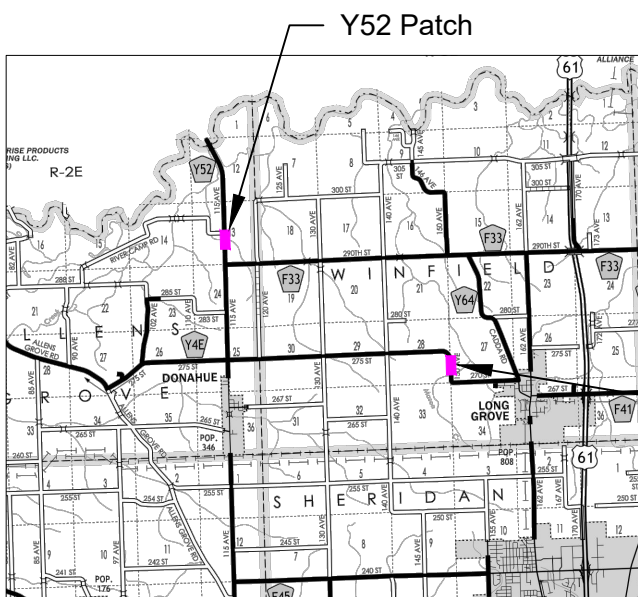

Y52 Patch

150th Ave Patch

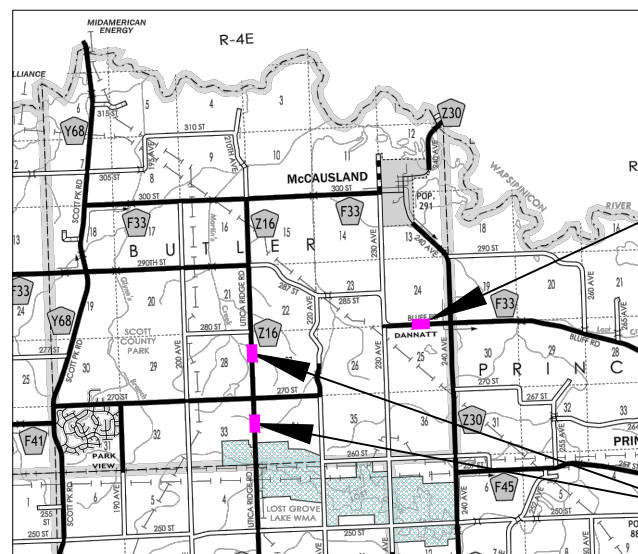

Bluff Rd. Patch

Utica Ridge Patches



Highway Division

PLANS OF PROPOSED IMPROVEMENT ON THE  
**SECONDARY ROAD SYSTEM**  
**SCOTT COUNTY**  
**HMA PATCHING**  
**2024**

Refer to the Proposal Form for list of applicable specifications

**PROJECT TRAFFIC CONTROL PLAN**

THROUGH TRAFFIC WILL BE MAINTAINED DURING CONSTRUCTION. LOCAL TRAFFIC TO ADJACENT PROPERTIES WILL BE MAINTAINED AS PROVIDED FOR IN ARTICLE 1107.08, 2023 STANDARD SPECIFICATIONS PLUS CURRENT SUPPLEMENTAL SPECIFICATIONS. THIS ROAD WILL BE OPEN TO ONE LANE TRAFFIC DURING CONSTRUCTION.

Traffic control devices, procedures, layouts, signing, and pavement markings installed within the limits of this project shall conform to the "Manual on Uniform Traffic Control Devices for Streets and Highways" as adopted by the Department per 761 of the Iowa Administrative Code (IAC) Chapter 130.

**UTILITIES NOTE**

The contractor is responsible for notifying all public utilities on the project in accordance with Article 1107.15 of the Standard Specifications.

To locate utilities dial IOWA ONE CALL  
 1-800-292-8989



INDEX OF SHEETS	
NO.	DESCRIPTION
A1	Project Title Page
B1	Typical Sections
C1	Estimated Quantities and General Information
TOTAL	3 Sheets

MILEAGE SUMMARY		
LOCATION	LIN.FT.	MILES
95th Ave	150	0.028
Y52	32	0.006
150th Ave.	30	0.006
Utica Ridge (South of 270th St.)	100	0.019
Utica Ridge (South of 280th St.)	35	0.007
Bluff Rd.	30	0.006
TOTAL	377	0.071

**ROAD STANDARD PLANS**

The following Standard Plans shall be applicable to construction work on this project

Identification	Date	Identification	Date
PM-110	04-21-20	TC-213	04-18-23
PM-420	10-15-19	TC-233	10-17-17
PM-520	10-15-19		



I hereby certify that this plan was prepared by me or under my supervision and that I am a duly licensed Professional Engineer under the laws of the State of Iowa.

Signature \_\_\_\_\_ Date \_\_\_\_\_  
 ANGELA K. KERSTEN  
 Printed or Typed Name

My license renewal date is December 31, 2025

Pages or sheets covered by this seal: A1, B1, and C1